

BERNINA L 4 SERIES

CUT, SEW, AND FINISH IN ONE STEP!

BERNINA L 460 AND L 450 OVERLOCKERS



made to create **BERNINA**

THE FAST AND THE FLEXIBLE WAY TO SEW!

Working with the L 4 Series overlockers means saving time and stitching fast. Sewing projects take shape quickly and with little effort. Innovative features make BERNINA overlockers delightfully easy to use, ensuring professional quality down to the very last stitch. The overlocker is the perfect machine to give your knit and woven projects that professional look inside and out.

EASE OF USE

Settings are adjustable while sewing, including the thread tensions, the cutting width from 3 to 9 mm and the stitch length from 0.8 to 4 mm. Effortlessly change the differential feed to ensure wave-free seams in knits and no puckering in fine fabrics. A manual needle threader allows for easy and ergonomic threading. The colour-coded threading paths as well as the lower looper threader support your quick threading.

ACCESSORIES

The most commonly used accessories are located in the looper cover, neatly arranged and ready to be used. The additional accessory box holds the seam guide, spool caps and tools. A range of optional feet for your creative overlocking are available.

MICRO THREAD CONTROL (mtc)

Micro Thread Control (mtc) makes over-the-edge thread loops disappear with a quick flip of a lever. This saves time and effort while ensuring consistent high-quality stitches, professional seams and finished edges.

ULTIMATE COMFORT

The well-lit, large workspace eases sewing as well as threading of loopers and needles. The L 460 also includes the BERNINA Free Hand System (FHS) that lowers and temporarily raises the presser foot, allowing both hands to be free for sewing and placing the fabric. The slide-on table expands the work space to support larger sewing projects (standard with the L 460, option available for the L 450).

DC MOTOR AND BERNINA FOOT CONTROL (L 460)

The BERNINA Foot Control, in combination with the DC motor, provides outstanding stitch-by-stitch speed control at up to 1,500 stitches per minute. Professional seams and hems of the highest stitch quality are produced in no time. The automatic needle stop up ensures the needles and loopers are always in the correct position for threading. Use the back-kick function of the BERNINA Foot Control to set the needle stop up or down for precise stitching and stopping.

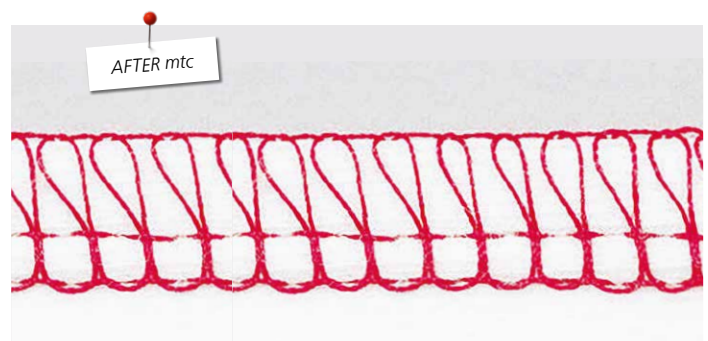
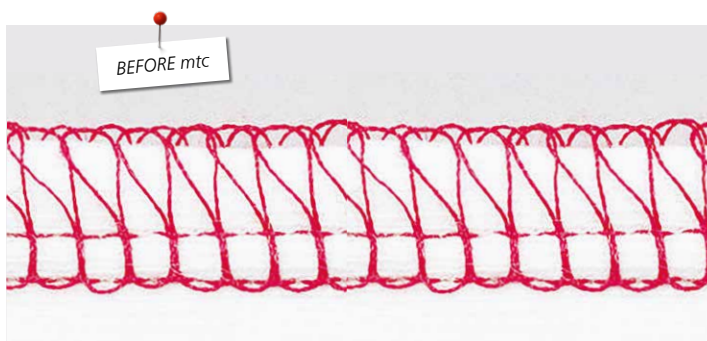

PRODUCE SEAMS AND HEMS OF EXCELLENT STITCH QUALITY

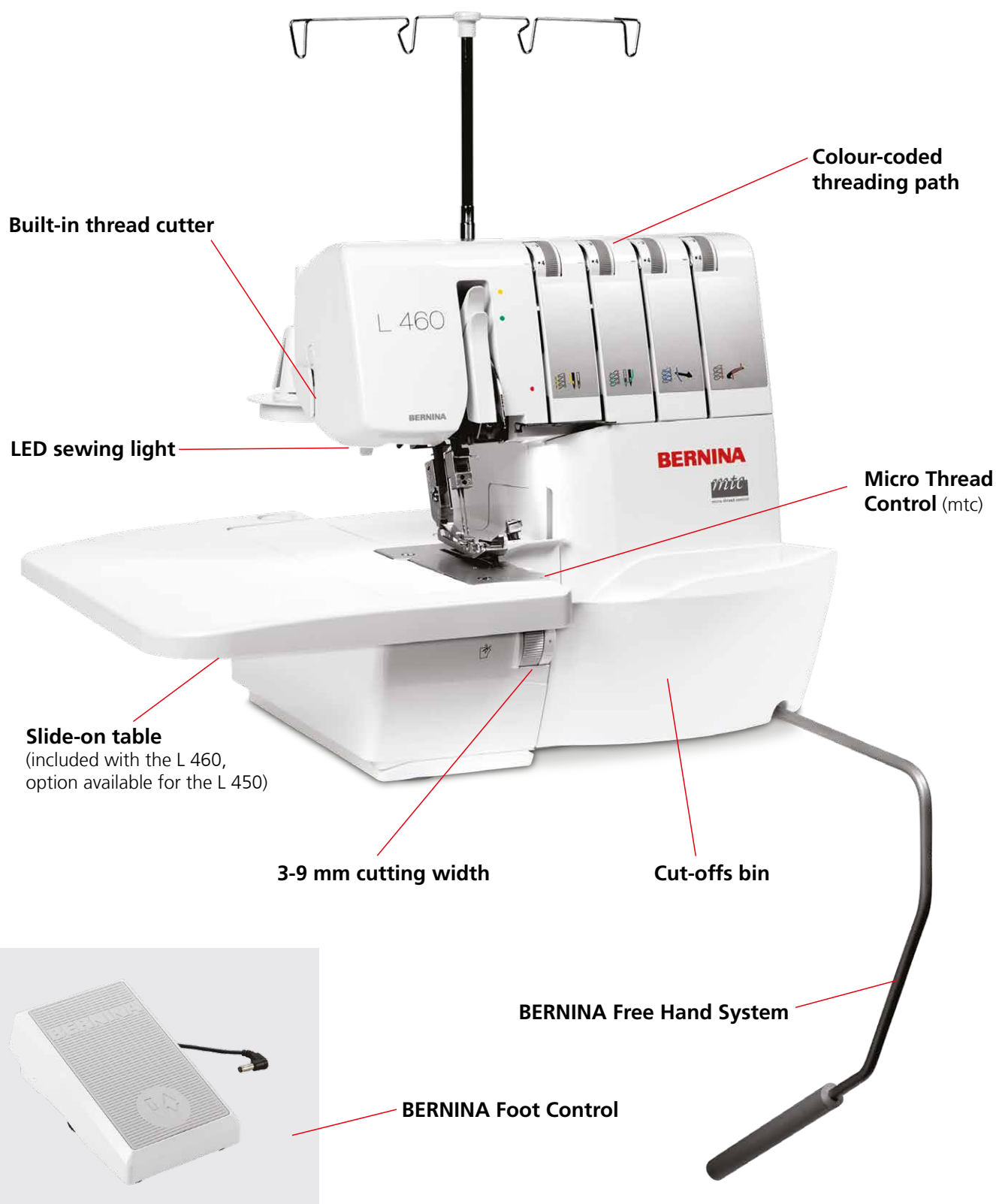

FEATURES AND FUNCTIONS

Stitch Variations	L 450	L 460
Total number of stitches	16	16
4-thread overlock	1	1
3-thread overlock (wide/narrow)	2	2
3-thread super-stretch	1	1
3-thread flatlock (wide/narrow)	2	2
3-thread narrow seam	1	1
3-thread rolled hem	1	1
3-thread picot stitch	1	1
2-thread overlock (wide/narrow)	2	2
2-thread flatlock (wide/narrow)	2	2
2-thread rolled hem	1	1
2-thread wrapped overlock (wide/narrow)	2	2

Comfort Features	L 450	L 460
Manual needle threader	✓	✓
Lower looper threader	✓	✓
Colour-coded threading path	✓	✓
Lay-in threading system	✓	✓
Handwheel position indicator	✓	✓
Automatic needle stop up	–	✓
Needle up/down with BERNINA Foot Control	–	✓
Thread tension release when presser foot raised	✓	✓
Stitch-by-stitch sewing	–	✓
Stitch length fine tuning for rolled hem	✓	✓
Adjustable stitch length while sewing	✓	✓
Adjustable differential feed while sewing	✓	✓
Accessories in looper cover	✓	✓
2 LED sewing lights	✓	✓
Safety switch activated when cover open or presser foot raised	–	✓

Technical Specifications	L 450	L 460
Micro Thread Control (mtc)	✓	✓
3–9 mm overlock seam width	✓	✓
Upper knife drive from below	✓	✓
2-step presser foot lift with additional front foot lift	✓	✓
5-step presser foot pressure	✓	✓
Rolled hem lever built into stitch plate	✓	✓
Motor	AC	DC
Sewing speed, stitches per minute	1,200	1,500

Standard Accessories	L 450	L 460
Standard overlock presser foot	✓	✓
BERNINA Free Hand System (FHS) with Knee Lifter	–	✓
Slide-on table	option	✓
Upper looper converter	✓	✓
Cut-offs bin	✓	✓
Seam guide	✓	✓
Set of needles	✓	✓
Tools and accessories in a separate box	✓	✓
Dust cover	✓	✓

Not all models and accessories are available in all countries. We reserve the right to make changes in both equipment and design. For further information, consult your BERNINA dealer. Errors and omissions excepted.

BERNINA L 460 Overlocker

- ✓ High-quality stitches
- ✓ Wave-free seams
- ✓ Free Hand System (FHS) with knee lifter
- ✓ Slide-on table for more space
- ✓ DC motor for finest sewing speed control
- ✓ Automatic needle stop up



BERNINA L 450 Overlocker

- ✓ High-quality stitches
- ✓ Wave-free seams
- ✓ Ease of use with Micro Thread Control (mtc)
- ✓ Bright LED lighting for needle and looper area



bernina.com/overlocker

made to create **BERNINA**

Visit bernina.com/overlocker to see our complete line of overlockers including our revolutionary One-step BERNINA Air Threading overlockers.

BERNINA recommends threads from 